

MANUAL

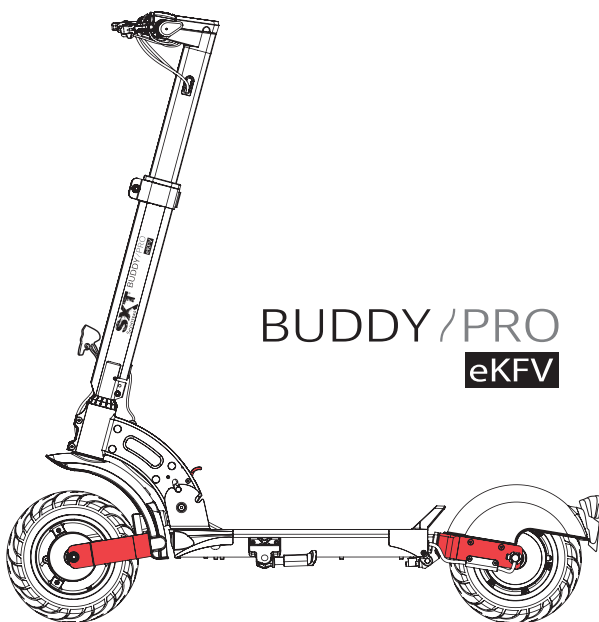

BUDDY/PRO
eKFV

Vehicle
BUDDY/PRO
eKFV

Manual - Version
SXT_MABDDYPR-E_V1.1



Download
Current manual

	Page
Scope of delivery	3
Technical data	5
Important information	6
Before driving	8
Serial Number	11
Unfolding	12
Folding	14
Vehicle parts	16
NFC card	18
Operation	19
LCD display	20
Error messages	21
Charging the battery	22
Maintenance, care, transport	24
Warranty	26
Troubleshooting	27



E-Scooter



Charger



Tool set



NFC Card



Manual

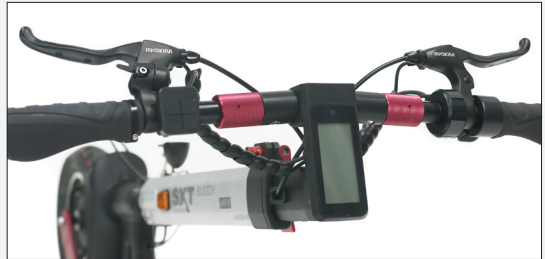

Max. Range (at 22°C / payload 70 kg): 65 km
Max. Speed: 20 km/h
Speed levels: 8km/h, 15 km/h, 20 km/h
Rated power: 500 watts
Drive type: brushless hub motor
Max. Load capacity: 120 kg
Max. Torque: 25 Nm
Length, width, height: 118 cm x 62 cm x 120 cm
Length, width, height (folded): 113 cm x 25 cm x 55 cm
Weight (incl. battery): 21.5 kg
Operating voltage: 52 Volt
Battery capacity: 13 Ah
Battery capacity: 676 Wh
Battery type: Lithium Ion
Battery removable for charging: no
Charger: 67.2 V, 2 A
Max. Charging time: 6.5 hours
Operation: thumb throttle
Suspension: shock absorbers front & rear
Braking system: drum brakes front & rear
Tires: Pneumatic tires 10 x 2.5
Tire size: 10 inch
IP protection class: IPX4
Vehicle Frame: Aluminum alloy
Wheelbase: 90 cm
Ground clearance: 13 cm
Handlebar height: 102 cm - 122 cm
Lighting: LED front & rear
Foldable, NFC, light sensor, STVZO approved: yes



For safe and proper use, carefully read the instructions for use and other documents accompanying the product and keep them for later use! The current version of the operating manual can be found with the product on our homepage www.sxt-scooters.de or via the QR code on the cover.

Why should this manual be read in detail!

This manual has been written to help you, the buyer, quickly and easily understand how to use and maintain the SXT Buddy PRO eKFV accurately & safely. It is important that you understand all the points and features of your new SXT Buddy PRO eKFV so that you can enjoy riding your new electric scooter from the very first minute. For the first ride, you should choose a large open area to familiarize yourself with the riding habits and features of the scooter. The SXT Buddy PRO eKFV requires a short break-in and braking phase related to all moving parts until this has taken your exact position perfectly. Before riding, always make sure that the folding mechanism is properly engaged and the safety lever is flipped.

The use of the electric scooter involves dangers. Various causes can lead to the failure of individual components through no fault of the manufacturer. Like other electric vehicles, the electric scooter is designed to move - this automatically involves the risk of losing control during the ride, falling or getting into dangerous situations that could not be avoided by training, practice or education. In such cases, despite the use of protective equipment or other precautions, you may be injured or, in the worst case, killed. **USE AT YOUR OWN RISK. USE COMMON SENSE.** This manual contains various warnings and safety precautions concerning the consequences of improper maintenance and care or improper use. Any accident could result in serious injury or, in the worst case, death - we do not repeat this warning regarding possible injury or, in the worst case, death at every point where such a warning is given.

- Use from a minimum age of 14 years.
- For your safety, we recommend wearing a bicycle helmet (CE certified according to test standard DIN EN 1078), as well as protectors for arms and legs.
- Observe the valid traffic regulations.
- Never use the vehicle in poor visibility.
- Never attempt stunts, wheelies or jumps - the product is not suitable for this. These things carry a great risk of accidents and irreparable damage to the product.
- Do not ride the scooter with more than one person at the same time.
- Do not ride under the influence of drugs or alcohol.

Notice and disclaimer

Riding a scooter involves the risk of accident and injury, including death. By using the product, you yourself are responsible for dislocations. Therefore, please always observe all rules of use, as well as the road traffic regulations in force in your country. The POL-Planet GmbH & Co. KG is not liable for any damage caused by accidents resulting from improper handling.

**DISREGARDING THE ABOVE INSTRUCTIONS AND DISREGARDING
NORMAL COMMON SENSE
THE RISK OF SERIOUS INJURY. USE THE CHARGER WITH DUE
THE CHARGER WITH DUE CARE.**

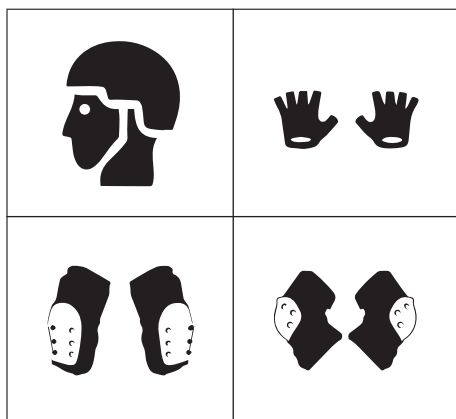

1. Always check the vehicle before driving it. Regular maintenance and care minimize the risk of damage, accidents and possible injuries.
2. Most dangerous injuries in falls or accidents are head injuries - Always wear appropriate protective equipment such as an approved helmet with chin strap. A helmet may also be required by law in your area. We also recommend elbow and knee protectors, long-sleeved outerwear, long pants, and gloves. Always wear sturdy footwear such as lace-up athletic shoes with rubber soles for firm grip. Never ride the scooter barefoot or in sandals and keep laces closed and away from wheels.
3. Always follow the road traffic regulations in force in your country.
4. Practice riding in a closed off open area.
5. This scooter is not designed for jumping, stunts or similar - likewise, avoid riding with only one hand on the handlebars. Always keep both feet on the footboard.
6. Do not ride the scooter up or down heels / steps larger than 3 cm - this could irreversibly damage the vehicle due to the shocks and vibrations that occur.
7. The maximum speed is 20 km/h.
8. Do not use the scooter in temperatures below 0°C.
9. Drive very slowly and carefully or get off the scooter if you find bad road conditions.
10. Do not use the scooter on oily or icy surfaces.
11. Please adjust the handlebar height to your height to ensure a safe ride.
12. To avoid damage to the electrical parts of the vehicle, do not drive through deep puddles of water or pressure wash with water.
13. Please do not ride in bad weather, such as heavy rain and strong wind.
14. Do not drive the scooter under the influence of drugs or alcohol.

Tire pressure:

Ensure the necessary tire pressure is maintained.

Mechanical Safety Check:

Before using the SXT Buddy PRO eKFV: Perform a visual inspection for any loose screws and other parts. Make sure everything is in place and no parts are missing or showing severe wear. If you are unsure, be sure to contact your dealer or Technical Support immediately!

Tires and wheels:

Check your tires for wear - to do this, spin them around to inspect them all the way around. Make sure that the tires rotate freely and that the brakes do not lock. If they do, please contact your dealer or technical support! Check the brakes and all mechanical functions before each ride.

1. Get to know the SXT Buddy PRO eKFV - before you ride it. Familiarize yourself with its driving behavior. Do not make tight turns, drive slowly and pay attention to your braking distance.
2. Do not overestimate your abilities. Learn to ride the SXT Buddy PRO eKFV best on a large flat area without obstacles.

Steering:

Steering on the SXT Buddy PRO eKFV is similar to steering on a bicycle, snowboard or while surfing. The handlebars should always be parallel to your body. Before each change of direction, make sure that the desired direction of travel is clear.

Riding Technique:

- Foot Position - Before you start riding, place your first foot as far forward as possible on the footboard while the second foot is on the ground. Make sure the road is clear.
- To start, kick the scooter with your foot, just as you would with a non-motorized one. As soon as you press the throttle, lean forward slightly so you don't fall backwards when accelerating.

- Avoid shifting your full body weight onto the handlebar grips when braking and accelerating.
- Always place your feet behind each other. The most comfortable stance is achieved with one foot in front and the second at an angle of 70-90° behind it - similar to skateboarding or surfing.

Braking:

Always shift your body weight to the rear when braking. The braking force is mainly transmitted through the feet and not through the handlebars - therefore it is a much more comfortable feeling when you are slightly „hanging on the handlebars“ instead of leaning forward.

Serial number / identification number:

Make a note of the vehicle identification number of your e-scooter. Keep this in a safe place. Each scooter has an individual number. This can be used to clearly identify your vehicle, e.g. in the event of theft.

How to find the frame number:

The number is located on the footboard at the front, left.



1. Press the RED pedal down to operate the folding mechanism by hand and unfold the handlebar.

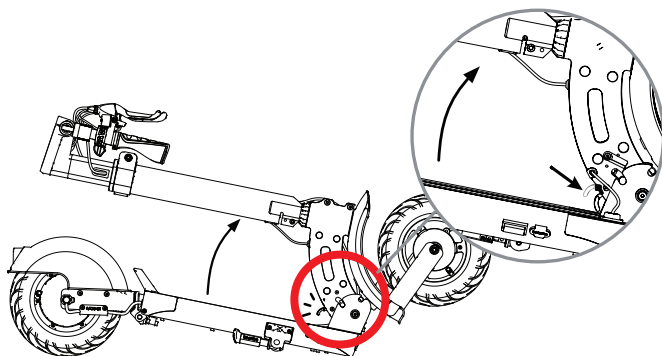

2. Pull the handlebar up and push it out until you hear the click of the locking mechanism.

Secure the folding mechanism with the RED SAFETY LOCK.

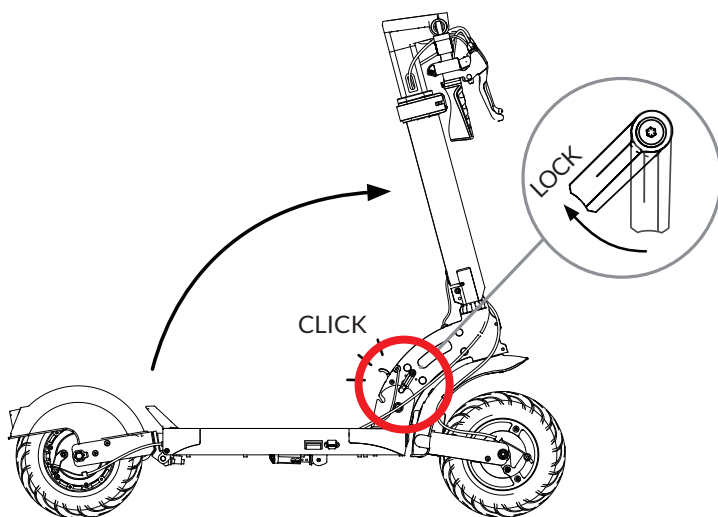

3. Fold out the handlebar until it locks into place.

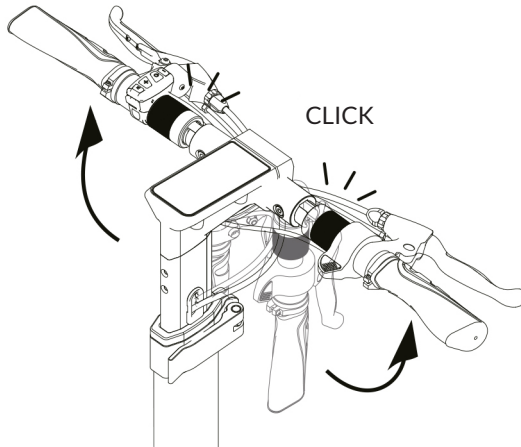

4. Open the RED quick-release fastener on the handlebar, slide the handlebar to the desired height and lock the fastener.

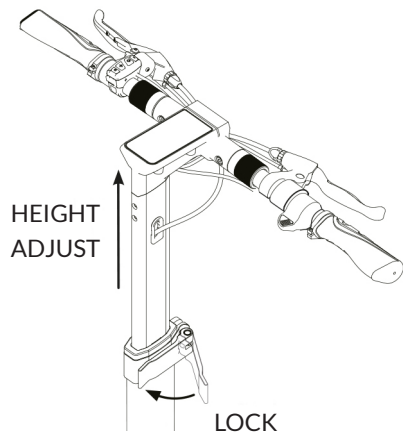
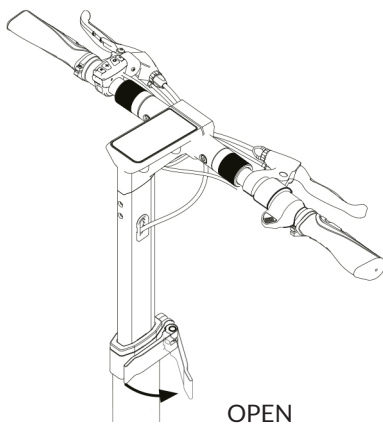

1. To fold the handlebars, push the RED locking sleeves to the side

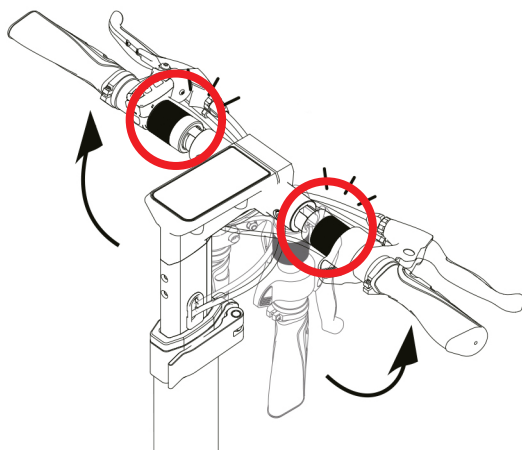

2. To fold en scooter, first release the RED SAFETY LOCK and push the handlebar forward firmly while at the same time pushing down the RED pedal with your foot to release the FOLDING MECHANISM

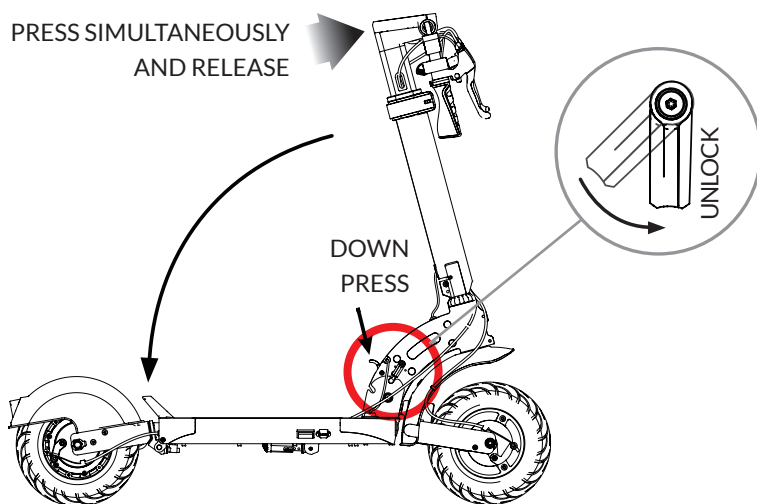

3. Once the scooter is folded properly, you will hear a clicking sound.

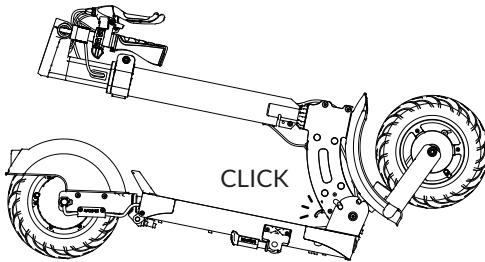

Description - Operating elements
see page 18 - 20.

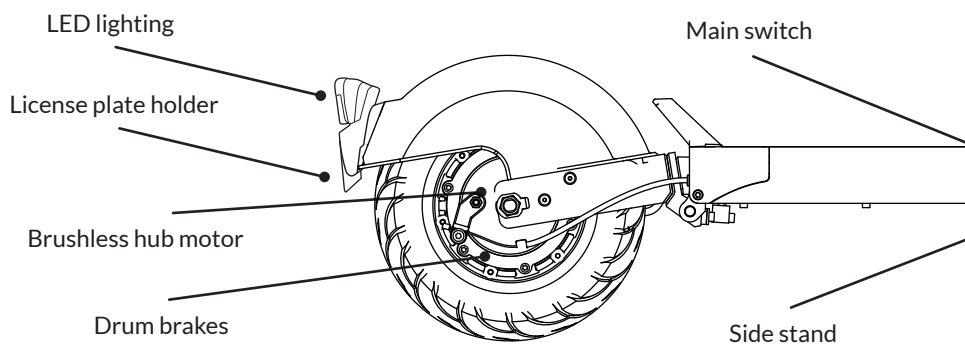

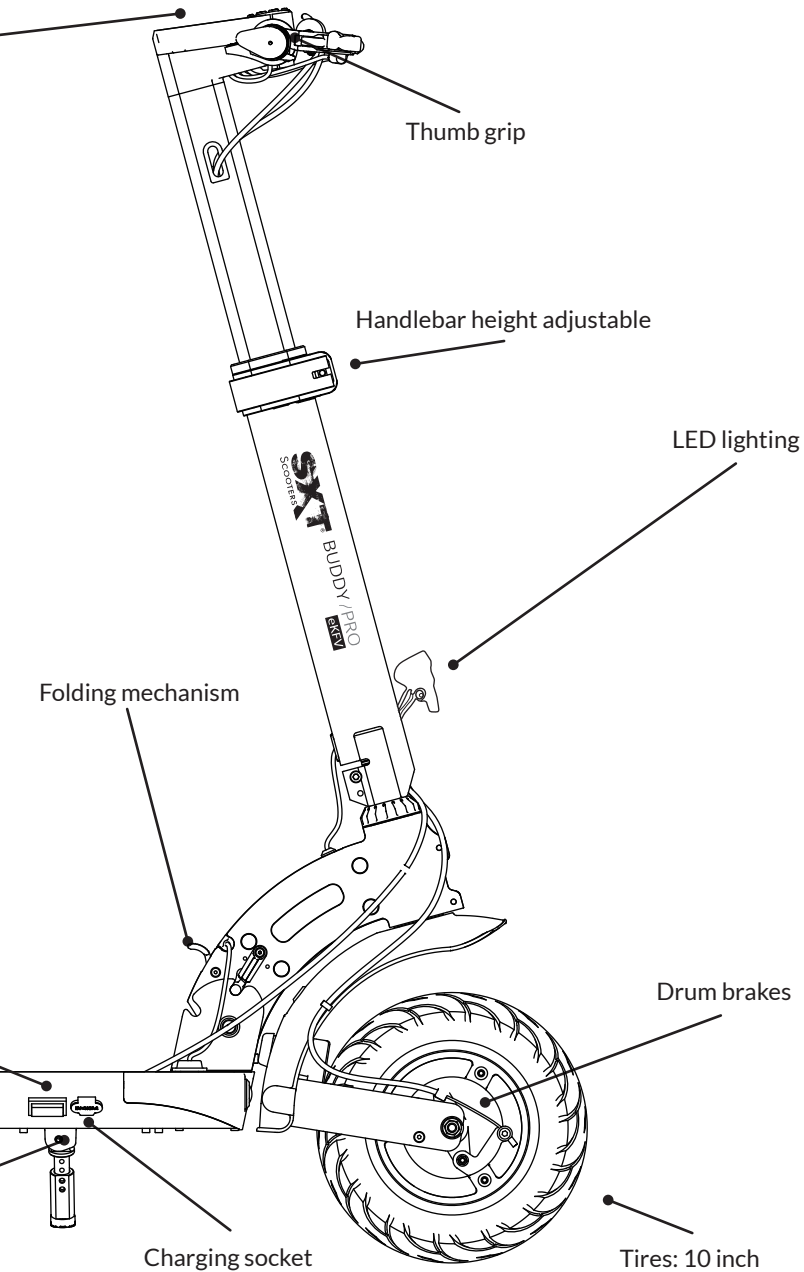

The NFC (Near Field Communication) card

To unlock your scooter (theft protection), you need the NFC card included in the delivery.

Attention: There are 2 cards in the package, please deposit the spare card in a safe place, if the cards can not be found, your scooter can not be unlocked.

Unlock scooter

To unlock your scooter, place the card on the sensor located on the right side of the handlebars. **①** Then LED's light up and you can now activate the scooter on the power button **②** on the left side of the handlebar.



Lock scooter

To activate the theft protection, first switch off the scooter at the power button **②**. Then place the NFC card back on the sensor **①**, the LEDs go out and the theft protection is active.



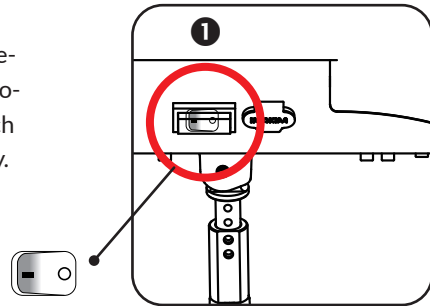

Attention: If you do not lock your scooter with the NFC card, there is no theft protection. Also, the scooter then consumes additional power which can lead to the fact that after several days the battery is deeply discharged and damaged.

Switch on the scooter:



In the front right area of the e-scooter, below the footboard, next to the charging socket is the main power switch ❶. Switch this on to activate the main power supply.

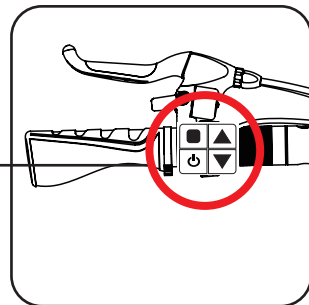

The following controls are located on the left side of the handlebar:

-  Menu control [+]
-  Switch on display, menu control
-  Menu control [-]
-  Light switch



To activate the scooter press the button , to deactivate the scooter press and hold the button for about 3 seconds . Please note that without NFC card the scooter can not be activated.

To switch on the light, press and hold the button  until the light comes on. When the scooter is switched on in the dark, the light sensor automatically switches on the light. This function can be varied as desired.

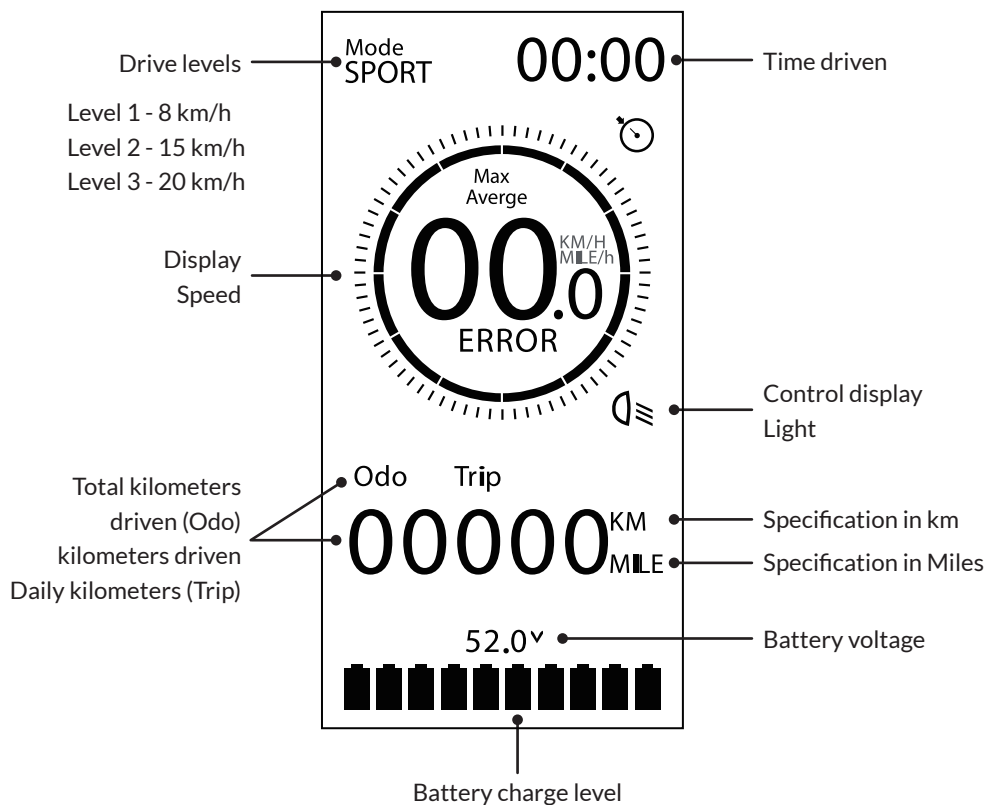

The following error messages may occur,
if a problem occurs in the electrical system.

Error 21 Error of the brake sensors

Error 22 Thumb throttle error

Error 24 Error of the motor

Error 40 Error in the control system

Charging instructions

The scooter should be charged in a well-ventilated room at a normal average temperature. First connect the charger to a standard power outlet, then connect the charging cable to your SXT scooter. When everything is connected, the red indicator on the charger will light up. The battery is full when the indicator light changes from red to green. At this point, you can remove the charger and replace the protective cover on the charging socket.

1. The safety protection for the charging port should be replaced after the scooter has been charged.
2. The scooter should be kept out of the reach of children during charging.
3. Under no circumstances should a charger other than the supplied one be used to charge the scooter. In addition, the supplied charger should be used exclusively for this scooter.
4. A charger that is not working should not be disassembled under any circumstances. Please contact the dealer.
5. The battery compartment should not be opened to avoid damaging parts inside the battery. If the battery does not charge, please contact the dealer.
6. To keep the battery in good condition, it should be charged at regular intervals, every 20 - 30 days.
7. Please remember to charge the battery after each use. If the battery is completely discharged, it may be damaged.
8. Do not connect the charger to the scooter if the charging cable or charging port is wet.

Open the rubber cover under the frame and connect the charger to the power socket.

Charging socket

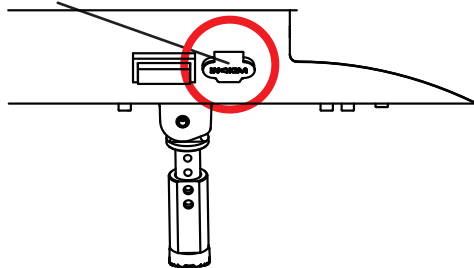

Charging instructions for lithium batteries

If your scooter has a lithium battery, please note the following:

Lithium batteries should never be deep discharged, this will irreparably damage the lithium cells. All lithium batteries should (if possible) always be stored at medium charge. If a battery is not needed for a long time, please do not fully charge it beforehand - this puts the lithium cells in unnecessary „stress“ which can lead to a shortened life span in the long run. If you have a choice when using the battery, we recommend in principle not to fully charge it, but always to use it in the medium voltage range. Of course, the battery can be fully charged to drive long distances, for example - it's just technically best for a lithium battery not to do this in order to really get the maximum performance and lifespan out of the battery.

Lithium battery life is expressed in charge cycles. Don't think you are „wasting“ many charge cycles by recharging the lithium battery more often even though it is not „drained“ - this is completely wrong! The indicated lifetime in charging cycles means so-called full cycles. This means that if you discharge your battery 50 % and then fully charge it again, this corresponds to ½ charging cycle. Charging twice corresponds to one full cycle.

We recommend recharging a lithium battery at 25 % residual charge up to approx. 75 % charge level. For long distances, however, the battery can of course be fully charged - see above.

During wintering or long storage of vehicles with lithium batteries, it is imperative to recharge them at least once a month to approx. 60 %.

For lithium batteries, use only the chargers approved and recommended by the manufacturer. Charging with too high a charging current in order to be able to charge faster can irreparably damage the lithium cells and, in the worst case, even lead to a fire.

Cleaning:

Please never wash the scooter with a water hose!

To reliably prevent rust, it is recommended to thoroughly clean and dry the vehicle after riding in the rain. The use of rust inhibitors is strongly recommended.



- Use suitable cleaning and care products and a soft sponge.
- Never use solvents.
- Never aim a direct jet of water at the following components: headlight, handlebar switches, display, brake lever, battery, charger.
- After washing, wipe with clean water to remove any cleaning residue.
- Dry with a leather cloth.

Storage and daily care:

When outside temperatures are around freezing, always make sure that all cables and brake cables are functioning properly. Do not park the scooter in the blazing sun or rain. Keep the vehicle clean and dry. Clean the scooter only with a soft cloth and without aggressive cleaning agents. Do not use alcohol, gasoline, acetone or other chemical solvents to clean the scooter, otherwise it may corrode.

After cleaning:

Perform some braking operations in a roadworthy place with extreme caution, as the water reduces the braking power for a short time.

Check all technical and electronic components.

Maintenance:

- Regularly check the screws and small parts on your scooter.
- Pay attention to regular maintenance and inspection of the individual parts.

Thank you for choosing one of our SXT Buddy PRO eKFV. You have a 24-month warranty on your scooter from the date of purchase.

Please note that there is no warranty if:

1. The warranty period has expired.
2. If you do not have an invoice and your order has not been recorded in the system.
3. The SXT Scooter has not been used properly.
4. Technical modifications have been made to the SXT Scooter.
5. The SXT Scooter has been stored improperly.
6. The SXT Scooter has been damaged in an accident.
7. If a non-original charger has been used.
8. If the SXT Scooter has been damaged by contact with water.
9. If the SXT Scooter has been used in extreme temperatures.
10. If original spare parts and/or accessories have not been installed.

In addition, wear parts such as tires and brake pads are not covered by the warranty.

For any technical issues not listed in this manual, please contact our Customer Service/Technical Support.



WARNING

To avoid serious injury, repairs to the battery must only be carried out by trained personnel. Please contact your dealer or our technical support if necessary.

You can find all spare parts and accessories on www.sxt-scooters.de

CONTACT TECHNICAL SUPPORT

POL-Planet GmbH & Co. KG.

Marie-Curie Straße 2 • 79618 Rheinfelden

Phone: +49(0)7623-460 460 • Fax: +49(0)7623-460 46 49

info@sxt-scooters.de • www.sxt-scooters.de



POL-Planet GmbH & Co. KG.
Marie-Curie Straße 2 • 79618 Rheinfelden
Phone: +49(0)7623 460 460
info@sxt-scooters.de • www.sxt-scooters.de